

## St. Cloud Rooftop Floor Plan I

Exclusive, versatile and completely unique, the St. Cloud rooftop offers the ultimate New York City function space for hosting corporate and social events that are sure to be memorable. Situated 17 floors above Times Square, the rooftop offers both indoor and outdoor space with unrivaled views of the city skyline.

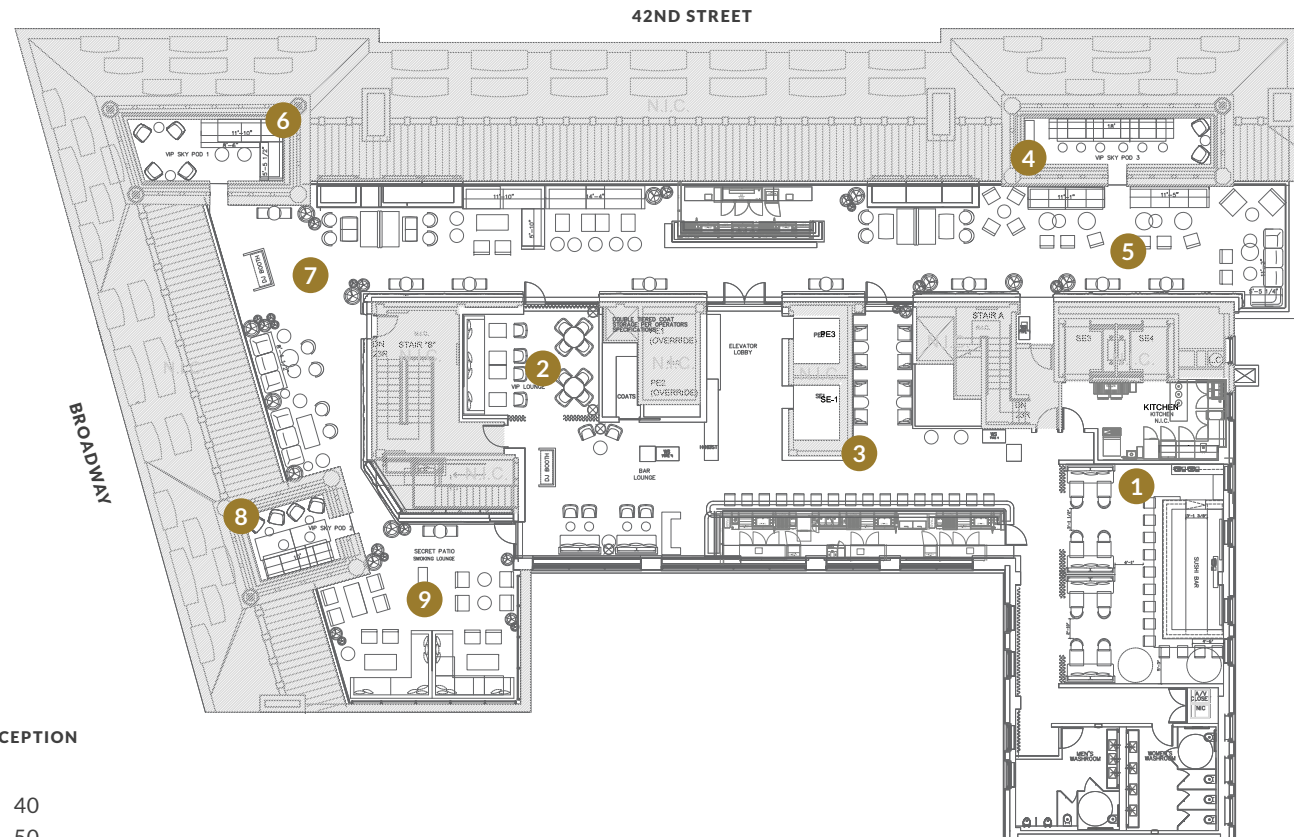

### ROOFTOP SQ. FEET SQ. METERS RECEPTION

#### INDOOR AREA

1. Akoya	800	74	40
2. The Astor Lounge	840	78	50
3. St. Cloud Bar & Perimeter Seating	1000	93	60

#### OUTDOOR AREA

4. 42nd Street Pod	200	19	20
5. 42nd Street Lounge	1500	139	80
6. Times Square Pod	240	22	15
7. Times Square Lounge	1000	93	125
8. Broadway Pod	140	13	10
9. Broadway Cigar Lounge	500	46	35

#### TOTAL ROOFTOP

7,800 SQ. FEET

724 SQ. METERS

250 RECEPTION

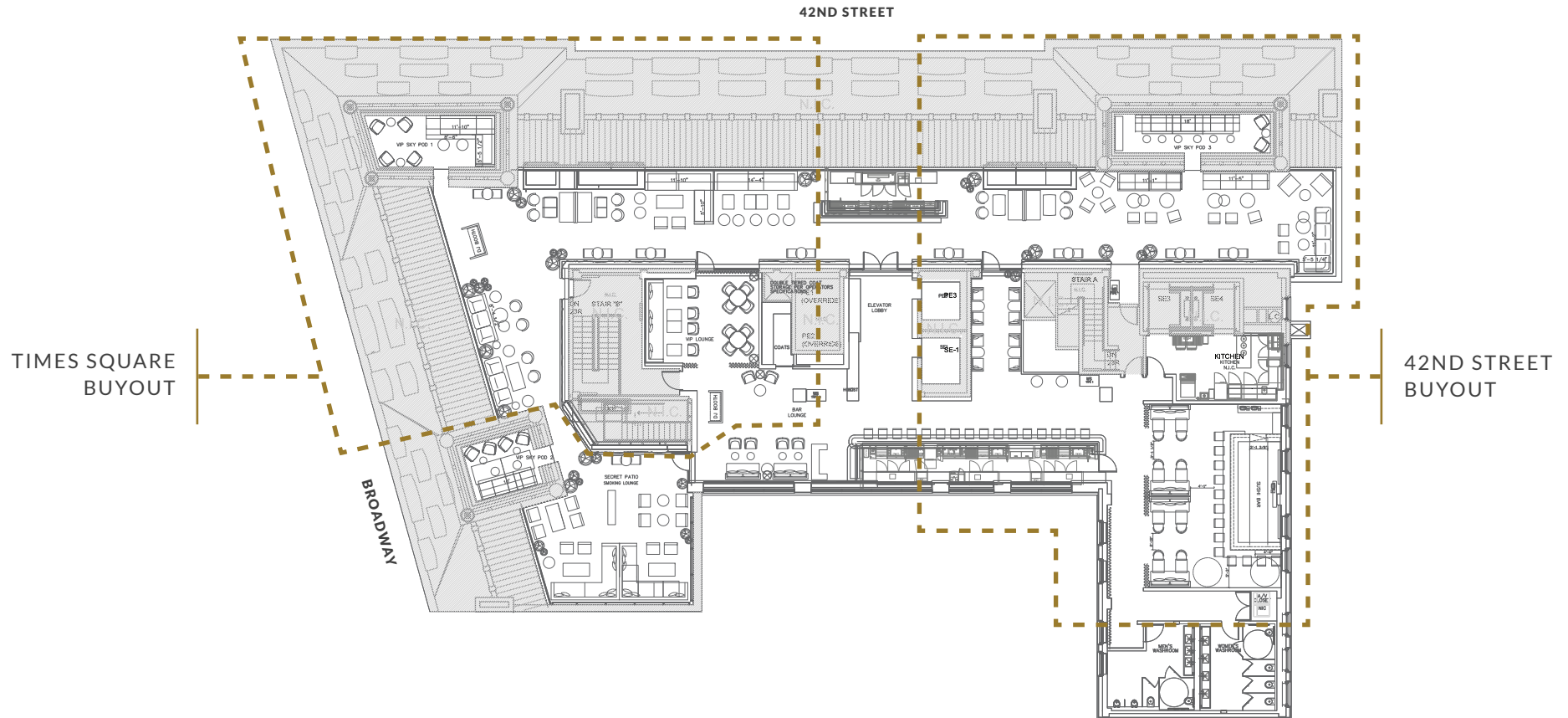

## St. Cloud Rooftop Floor Plan II

The St. Cloud rooftop can be reserved in its entirety or as two partial configurations that each offer indoor and outdoor event space.

BUYOUTS INDOOR & OUTDOOR	SQ. FEET	SQ. METERS	RECEPTION
Total Buyout, Indoor & Outdoor	7,800	724	250
42nd Street Partial Buyout, Indoor & Outdoor	2,500	232	175
Times Square Partial Buyout, Indoor & Outdoor	2,700	251	125